

GLUE THESE TOGETHER

TURNTABLE HEIGHT: 20mm

TURNTABLE DESIGN
 CONS&STUFF
 23 August 2017
<http://consandstuff.pancakeapps.com/>

(5V) GND DATA DATA

(5V) GND DATA DATA

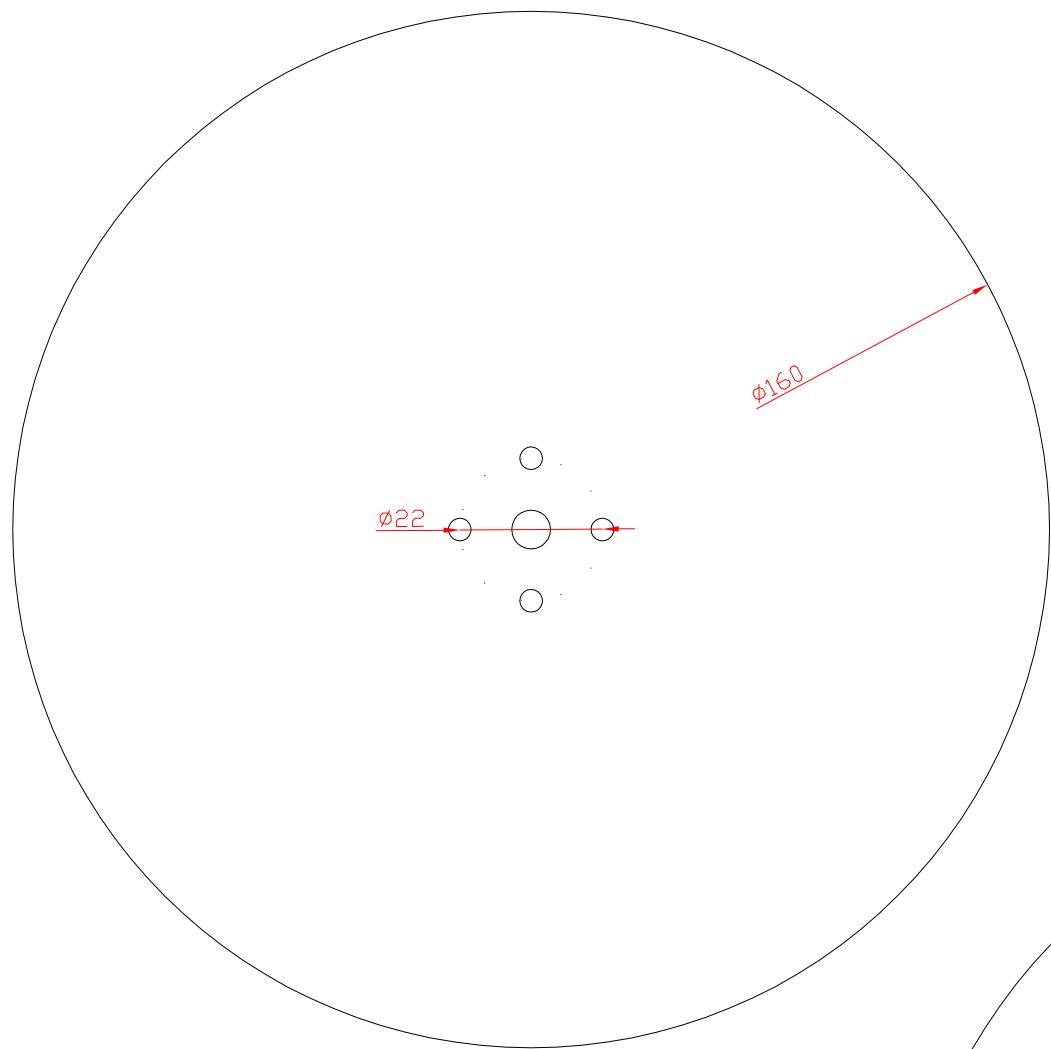

A:
 TURNTABLE DISC
 5mm CLEAR/BLACK ACRYLIC
 3.5mm BOLT HOLES
 6mm CENTER HOLE

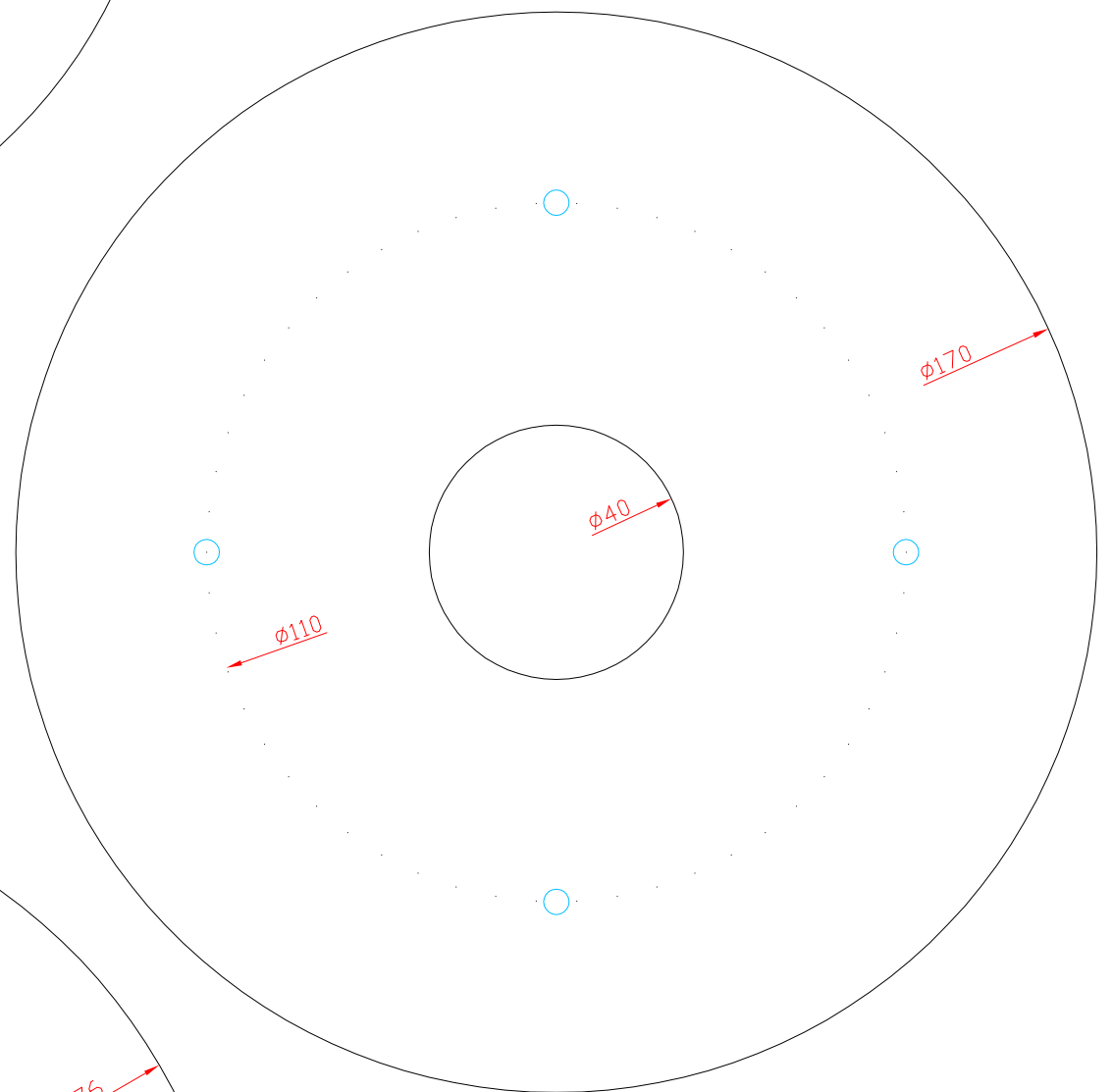

B:
 TURNTABLE BASE 1
 5mm CLEAR ACRYLIC
 4mm BOLT HOLES

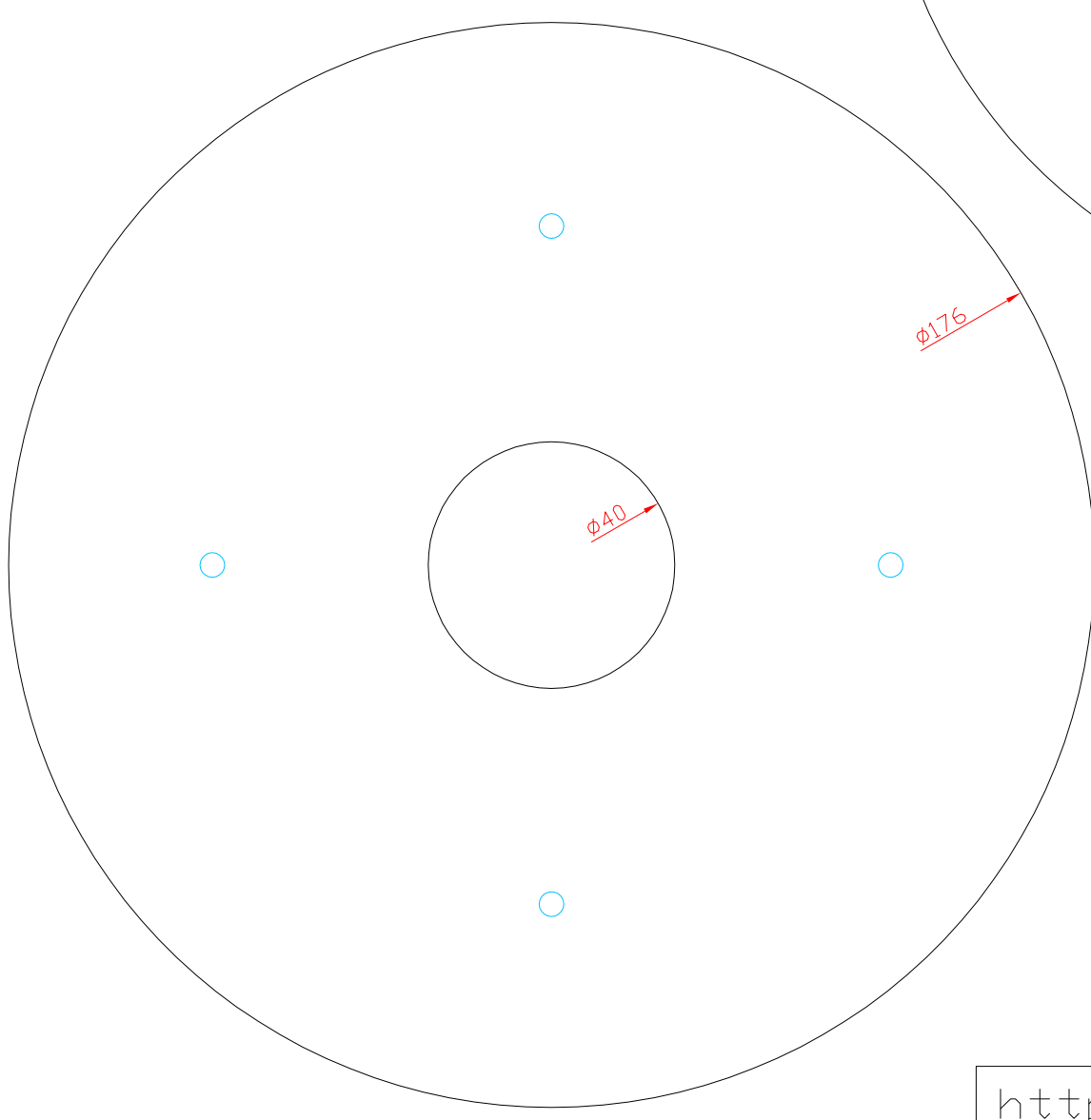

C:
 TURNTABLE BASE 2
 5mm CLEAR ACRYLIC
 4mm BOLT HOLES

TURNTABLE DESIGN
 CONS&STUFF
 23 August 2017

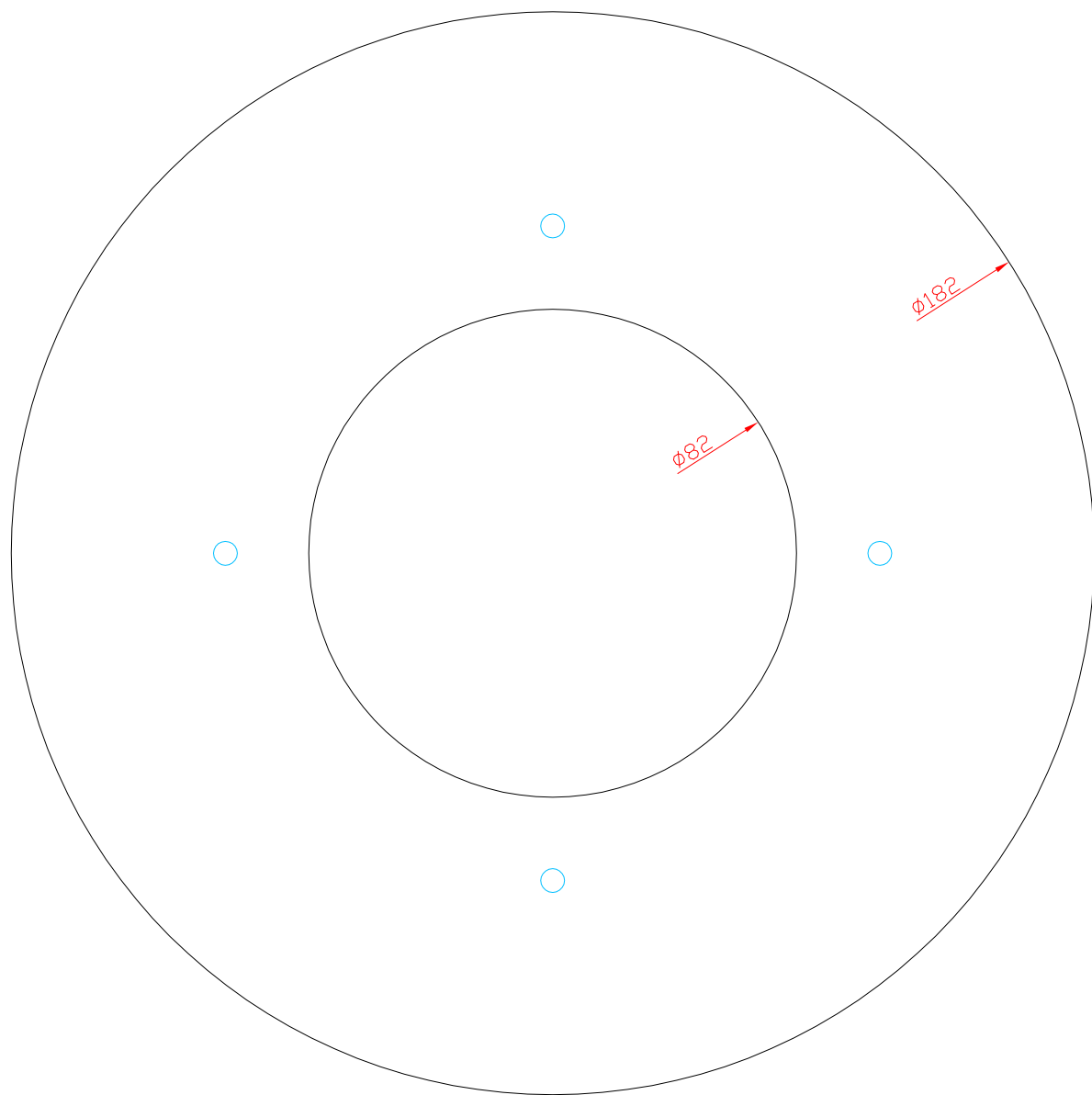

D:
 TURNTABLE BASE 3
 5mm CLEAR ACRYLIC
 4mm BOLT HOLES

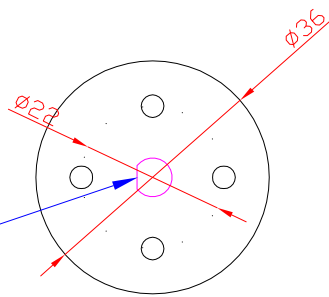
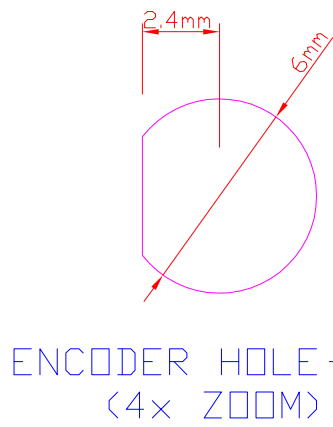

E:
 SPINNING CENTER 1
 5mm CLEAR ACRYLIC
 3.5mm BOLT HOLES

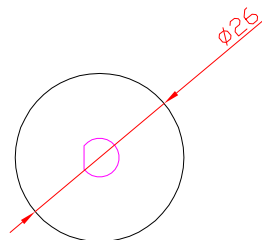

F:
 SPINNING CENTER 2
 5mm CLEAR ACRYLIC
 6mm ENCODER HOLE

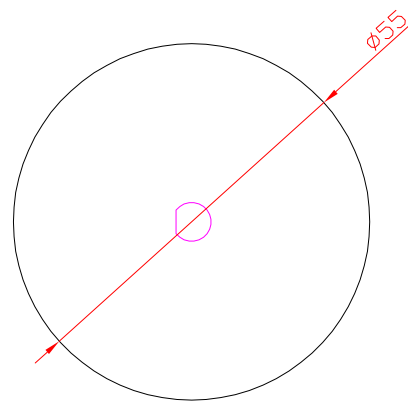

G:
 SPINNING CENTER 3
 5mm CLEAR ACRYLIC
 6mm ENCODER HOLE

The three spinning center pieces must be glued together aligned on the center.

You can use acrylic/plexiglass glue, or Loctite Super Glue.

Keep the 3 encoder holes centered.

TURNTABLE DESIGN
 CONS&STUFF

23 August 2017

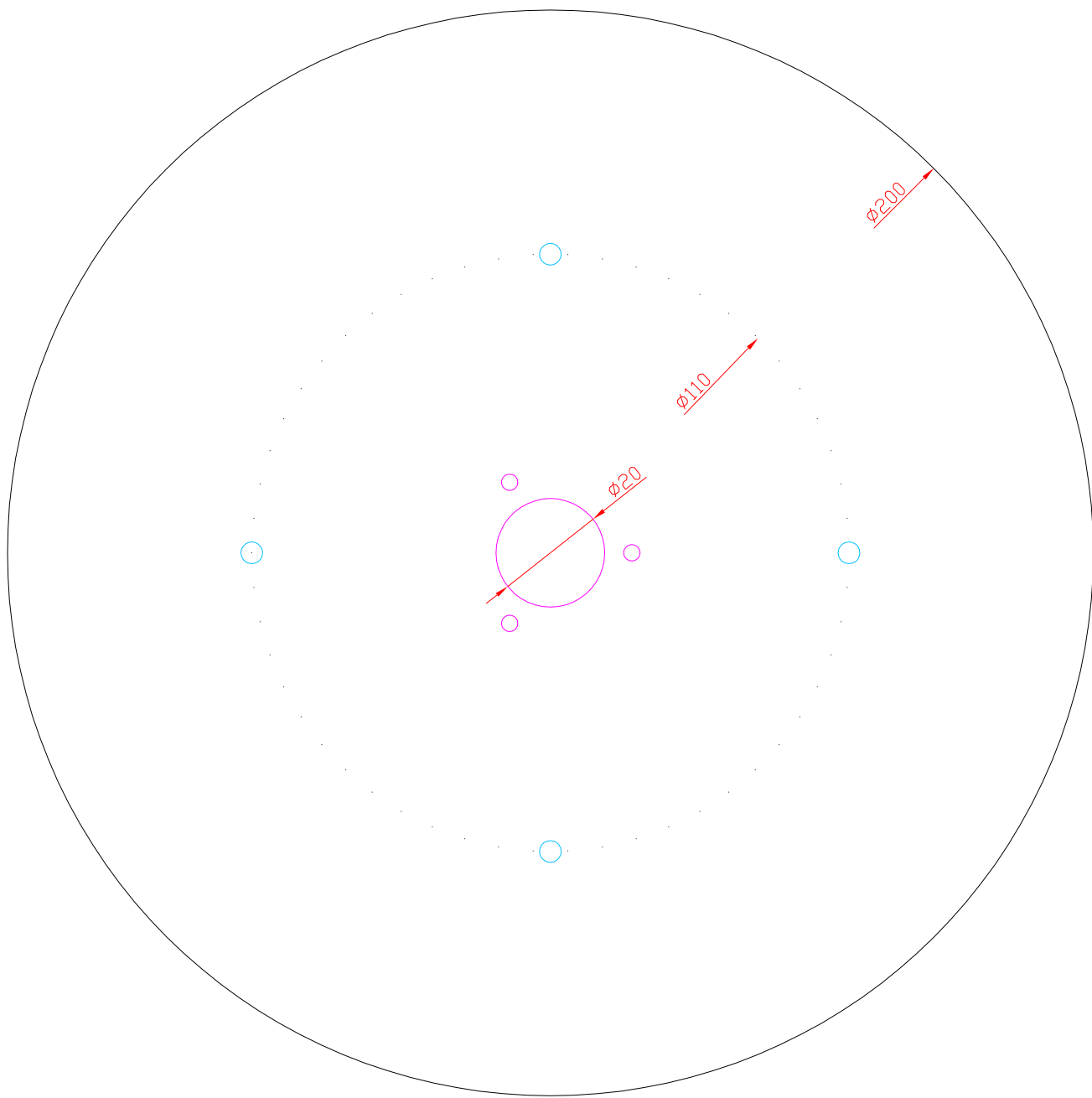

H:
 TURNTABLE BASE 4
 5mm CLEAR ACRYLIC
 4mm BOLT HOLES
 3mm M3 bolt holes
 20mm ENCODER HOLE

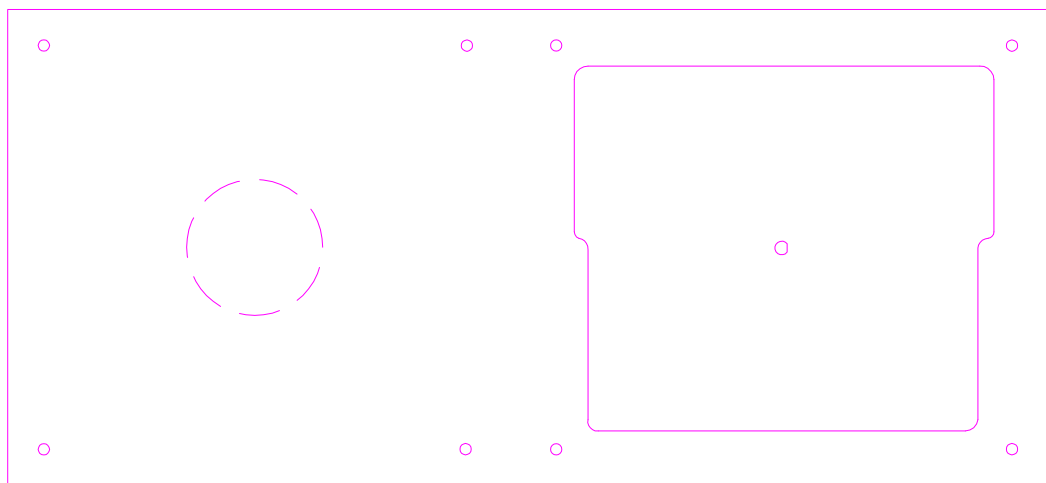
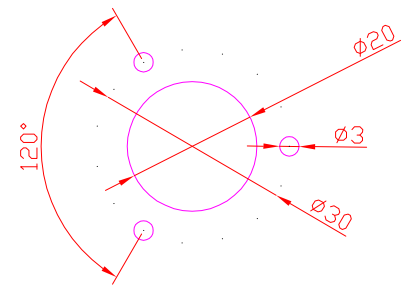

I:
 CONTROLLER TOP PLATE
 3mm BLACK ACRYLIC
 5mm M5 BOLT HOLES
 50mm CENTER TT HOLE

Check the measures on
 the complete guide-->



TO MAKE THE HOLES FOR THE M3
 M4 AND M5 BOLTS, YOU'LL NEED ONE
 OF THESE DRILL BITS, SHOWN IN THE
 PICTURE ABOVE.

TURNTABLE DESIGN
 CONS&STUFF

23 August 2017

<http://consandstuff.pancakeapps.com/>

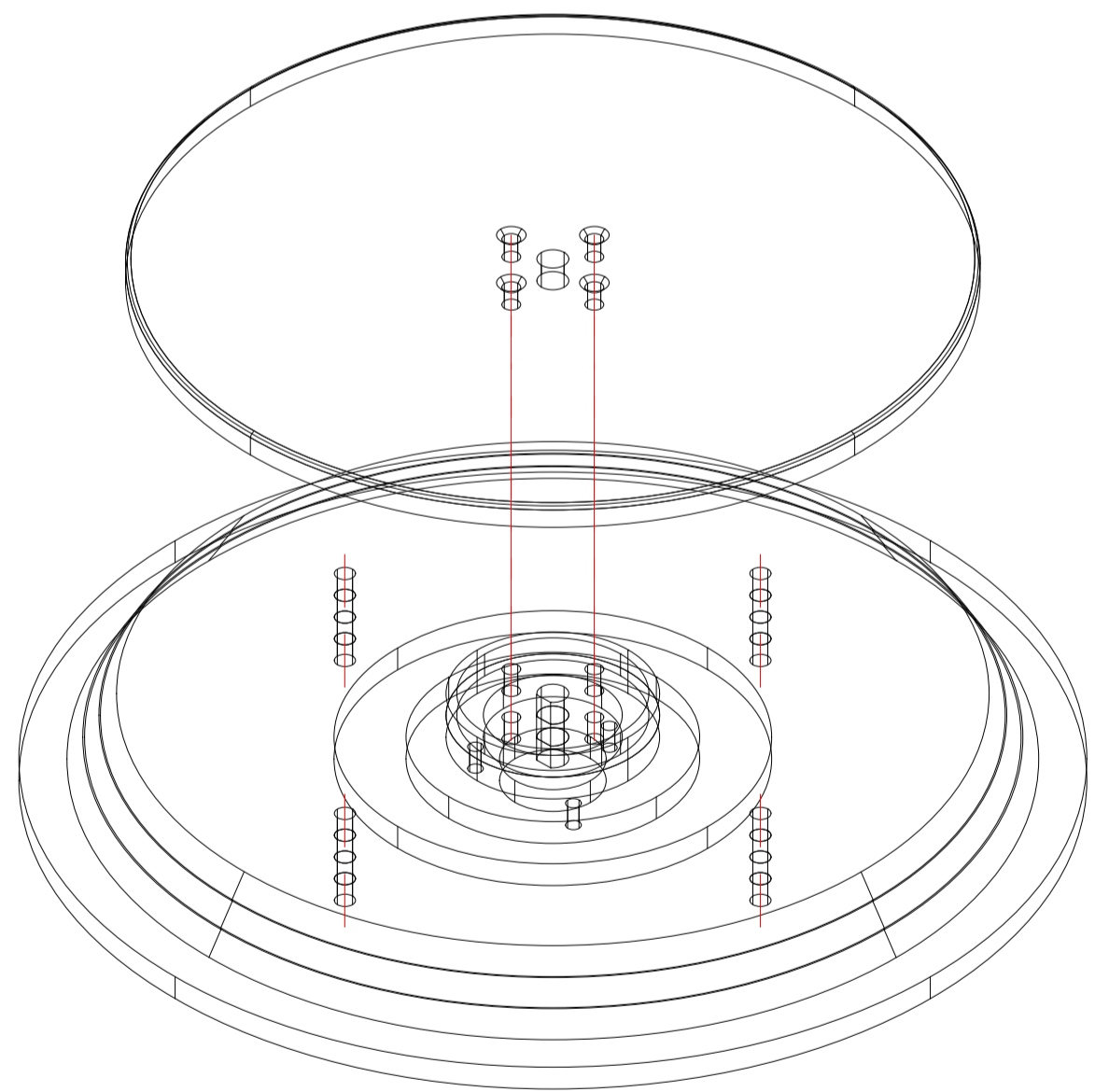
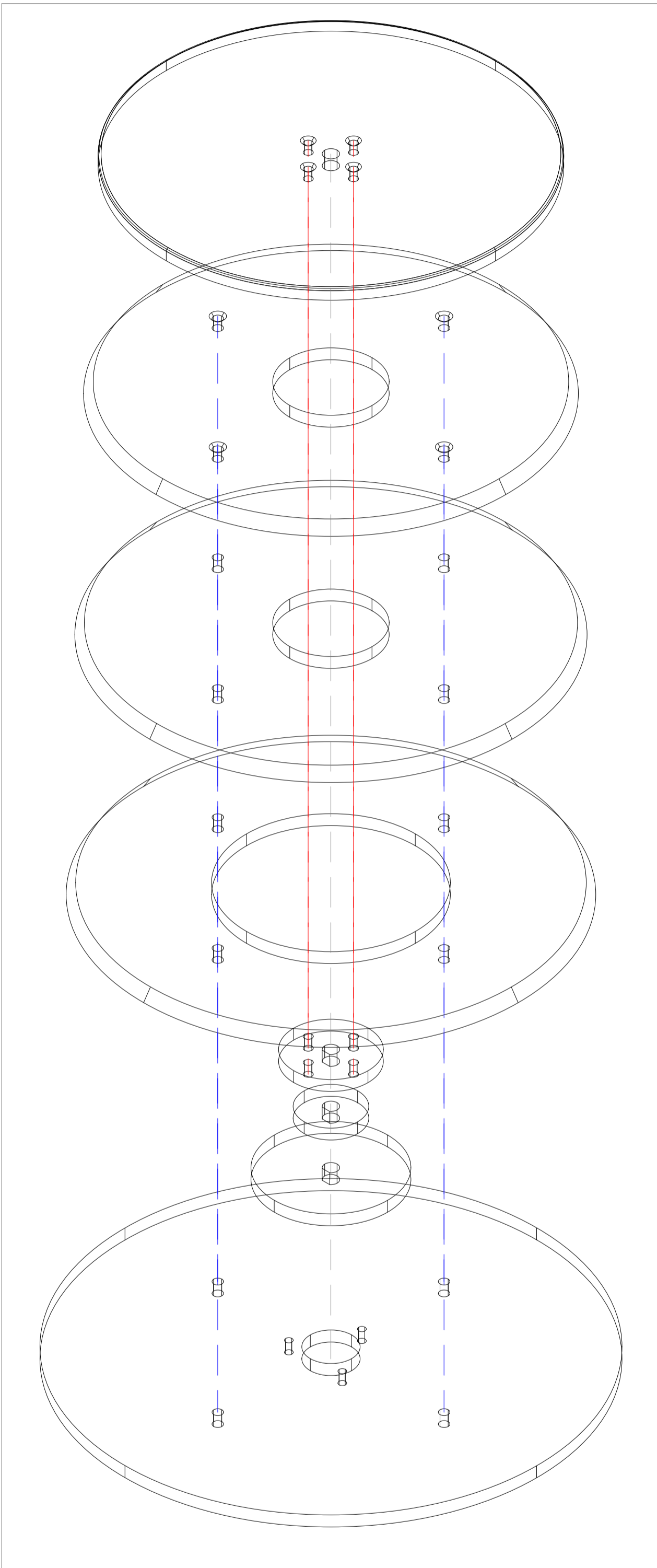

TURNTABLE DESIGN
CONS&STUFF

23 August 2017

<http://consandstuff.pancakeapps.com/>

